

# Bearings

## Spare parts guide

### Bearings

#### A small cost for big savings

##### More BAC bearing benefits

All BAC bearings are specifically designed for cooling tower application and tested in our [R&D laboratories](#).

##### Longer service life

- Longer **bearing L<sub>10</sub> life** of 80,000 hours compared to other bearings on the market.
- Unique specification for operation in **harsh conditions**, within a moist and hot environment.

##### Installing a BAC bearing will give you reliable operation:

- The **continuous operation** of the cooling tower is ensured, avoiding loss of production because of downtime.
- Frequent replacement or service work is avoided, which means you **do not face this high cost**.
- Your fan shaft, propeller and other drive elements can all **work as they should** with a BAC bearing installed, which is not the case when a non BAC bearing is installed.

##### Easy installation

- The **BAC bearing kit**, supplied with the required mounting hardware, offers quick and easy installation.

1. BAC bearing; 2. grease nipple; 3. rubber flinger (depending on the application); 4. flinger collar; 5. nuts and bolts for installation.

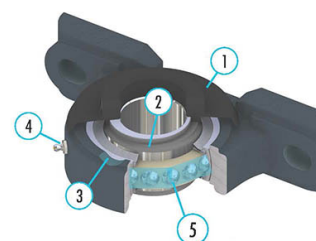
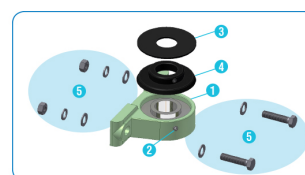



### Features that make our bearing unique!

1. An engineered **flinger** with integrated collar, specifically designed for BAC.  
This rides in a special machined cross section in the housing to repel water.
2. A **3-piece R-seal** including outboard and inboard flinger.
3. Special **housing an notch** , machined to prevent water collection.
4. The grease fitting **location** is unique.  
This ensures full evacuation of old, contaminated grease out of the bottom.
5. **Grease** that outperforms most common available greases.  
This ensures an **extended** grease life and **better** rust resistance.

### Maintenance tip !

When replacing bearings, replace all bearings on the shaft together for optimum performance. Also consider replacing additional drive components, at the same time, for **reduced maintenance downtime**.

After replacement make sure the bearings are properly **greased** and **protect** all parts with soft seal protective product.

(grease cartridges and soft seal are available from BAC)

**Want to replace the bearings of your BAC cooling equipment?**  
Contact your [local BAC representative](#).

## Downloads



- [BAC Rodamientos de Torres de Refrigeración](#)
- [The SERVICE EXPERT for BAC Equipment](#)